



CEODEUX

LPG-TEC

NEW

NEW Polyvalves "Europe"
for automotive LPG and forklift applications
acc. to the european regulation R67/01



**A613
Standard**

What's new:

- Highly standardized version for easy ordering, no more complicated forms
- New flexible plastic dip tube and safety tube for easy mounting
- Optimized body, light weight
- New float lever, shape retaining material returns to initial shape even after bending, easy mounting
- New levelgauge linking system, failsafe
- Better than ever, all previous top of the line specifications remain



**ROTAREX
Group**

CEODEUX LPG-TEC

24 route de Diekirch, L-7505 Lintgen, Luxembourg
Tel: +352 32 78 32 1 , Fax: +352 32 78 32 800
e-mail: info@lpg-tec.rotarex.com , www.rotarex.com



CEODEUX
LPG-TEC

POLYVALVE "light version" Type A613 Standard market

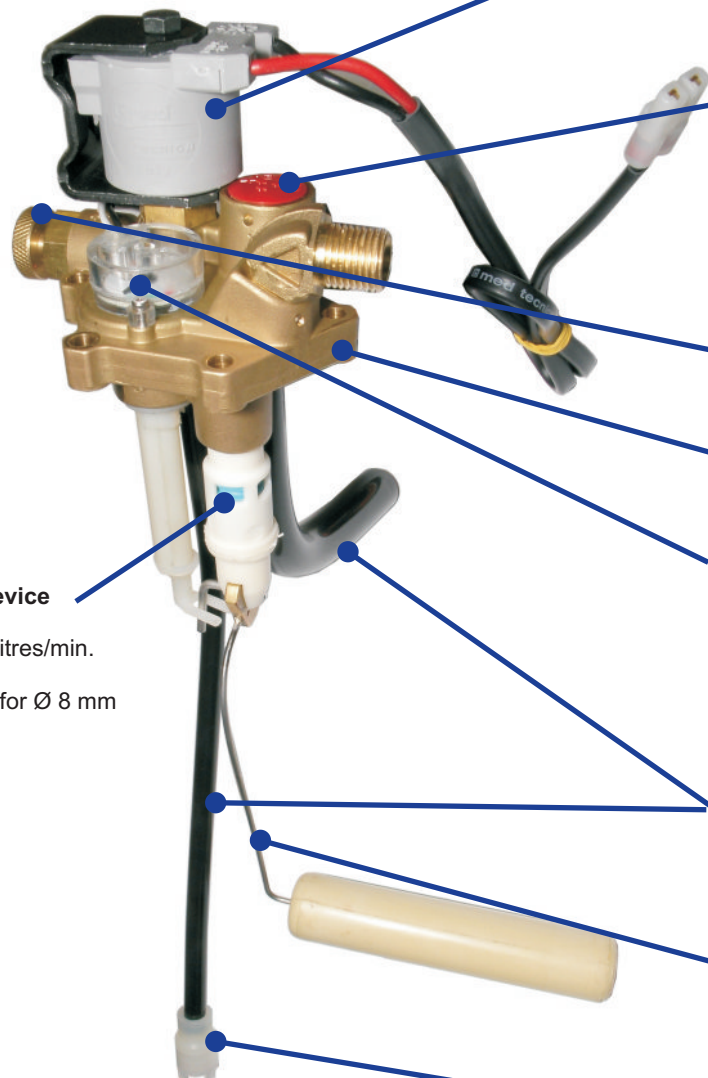

Solenoid Service Valve

- with excess flow device
- Manual shut-off valve allowing the exchange of the coil under pressure
- coil 12 V / 24 V DC
- flexible dip tube
- Connection: NIOXI, for tube Ø 6mm
- option: Elbow 1/8"NPT

Safety relief Valve

- Setting 27 bar
- Discharge rate > 17,7 Nm³ air/min.
- This discharge rate is suitable for LPG tanks with a capacity of +/- 100 litres
- Tube relaying safety relief into vapor phase under all mounting angles

Shut-off valve

New optimized body

- Lighter

Liquid Level Gauge

- Resistive sending unit
- Other connectors on request
- Interchangeable under pressure
- Improved linking system
- Direct reading level gauge
- 0 to 90

Dip tube and safety tube

- new plastic material
- flexible
- easy mounting

New float lever, shape retaining material

- No more deformation
- Returns to initial shape even after bending
- Easy mounting

Filter

assembled to the tube's end

Standard 80% Fillstop Device

- with double back check
- large filling rate min. 40 litres/min. For p>8bar
- Connection: G1/4" male for Ø 8 mm

Order Form Standard Polyvalve

A613 (30° in **D** or **C**)

Ø of tank	Height	Reference of product	Qty
D600-650	H220-240	A6130001	
	H250	A6130002	
	H270	A6130003	

Non Standard (**A** or **B**)

Ø of tank	Height	Reference of product	Qty

• Always indicate Tank Manufacturer: _____

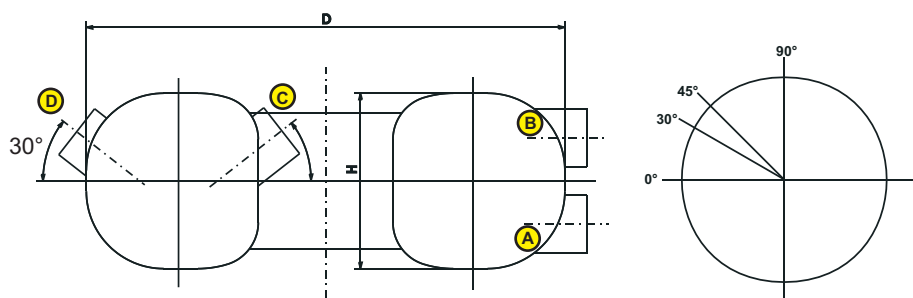

CEODEUX LPG-TEC

24 route de Diekirch, L-7505 Lintgen, Luxembourg
Tel: +352 32 78 32 1 , Fax: +352 32 78 32 800
e-mail: info@lpg-tec.rotarex.com , www.rotarex.com



ROTAREX
Group